

The Autopuller

By CLAY DELAY

Model APHC-D

with Buzzer and Time Delay

Owner's Manual



CLAY DELAY
115 Roycroft Dr. West Seneca NY 14224
Phone 716-674-4489 E-mail: autopullers@claydelay.com
www.claydelay.com

CLAY DELAY
115 Roycroft Dr. West Seneca NY 14224
Phone 716-674-4489 E-mail: autopullers@claydelay.com
www.claydelay.com

Notes

Model APHC-D is a handheld target machine release with a counter, and the provision to delay the release of the target.

Operation is simple:

Turn on using the top rocker switch. In the Instant mode, a target is released at the press of the button. In Time Delay mode, the target is delayed by the preset time for the delay.

Press the button that corresponds to your desired target and the target is released. The counter will advance one count for a single and two counts for a double.

Holding the button down will not give multiple targets. You must press the button for each target launch you want.

Machine Signal

Machine signal adjustment:

If you have a slower cycling machine, you may have to increase the machine signal length.

To adjust:

1. Unplug controller from target machine.
2. Plug the reset box in side of controller.
3. While pressing and holding the right button turn the controller on in **instant** mode. Count to 3 then release the right button.
4. Press the reset box button, and hold until the counter resets to 0. Release the reset button.
5. The counter will now advance to the current signal value.
6. Reset the counter again.
7. Press and release (or hold) the right button on the controller until the new desired value is displayed.
8. Press the center button to store the value. The display will go back to 0 once value is stored.
9. Turn off, wait 2 seconds, turn on and use.
10. The new machine signal length will now be used.

The base time is .4 second machine signal. Each count on the display will add .1 seconds. A count of 10 will give a signal of 1 second. A count of 15 will give a signal of 1.5 seconds. The max time is 3 seconds, a count of 30.

Counter Reset



Counter Reset

Resetting the counter:

1. Unplug the Autopuller from the course before resetting.
2. Plug the reset box cable in the side jack.
3. Turn the Autopuller on.
4. Press and hold the reset button on the top of the reset box.
5. The signal light on the reset box will come on steady and approximately 3 seconds later, the counter will reset.
6. Release the reset button, unplug the reset box, and turn the controller off.

Machine Signal

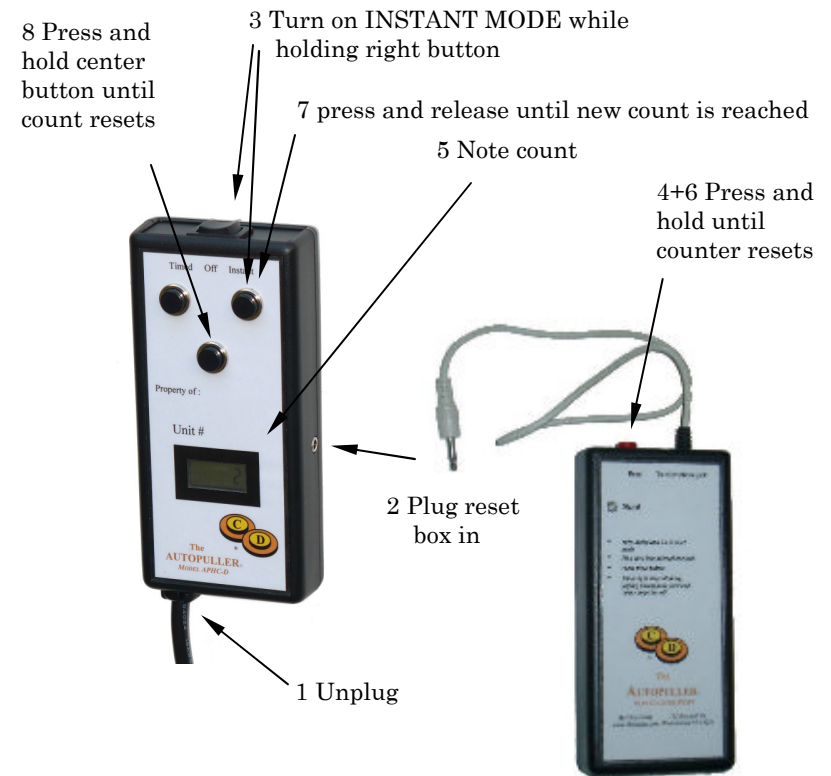

Time Delay

Time Delay

Time Delay adjustment:

To adjust the delay time:

1. Unplug controller from target machine.
2. Plug the reset box in side of controller.
3. While pressing and holding the right button turn the controller on in **timed** mode. Count to 3 then release the right button.
4. Press the reset box button, and hold until the counter resets to 0. Release the reset button.
5. The counter will now advance to the current signal value.
6. Reset the counter again.
7. Press and release (or hold) the right button on the controller until the new desired value is displayed.
8. Press the center button to store the value. The display will go back to 0 once value is stored.
9. Turn off, wait 2 seconds, turn on and use.
10. The new time delay value will now be used.

The range is 1 to 10 seconds. Each count on the display will add .5 second. A count of 2 will give a delay of 1 second while a count of 10 gives a delay of 5 seconds.

